

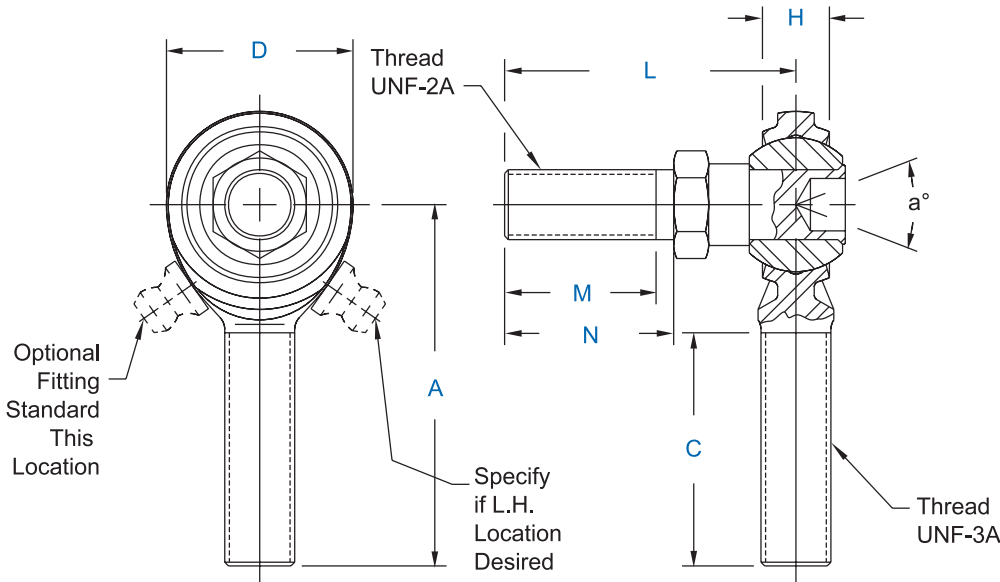

CM-S & CB-S Series Male Rod Ends With Studs

General Purpose - Economy



Optional grease fitting is supplied, standard, in **right hand** location as illustrated (with stud facing you). Specify if **left hand** location is desired.

Specifications
Body - Carbon steel, protective coated for corrosion resistance.
Ball - Sintered steel, heat treated, oil impregnated.
Stud - Carbon steel, protective coated for corrosion resistance. Right hand thread standard
Notes
Studs are available on all rod end series (Ex. - MM-8S). 2's & 16's available in "M" series.

Rod End No.		DIMENSIONS IN INCHES								a° Misalign. Angle	Ultimate Radial Static Load Capacity Lbs.	Approx. Brg. Wt. Lbs.
Right Hand	Left Hand	H Ref.	A ± .015	D Ref.	C +.062 - .031	L ± .015	N ± .010	M Ref.	Thread UNF-3A			
CM-3S*	CB-3S*	.234	1.250	.625	.750	1.000	.500	.437	10-32	50	Consult Aurora Bearing Engr. Dept.	.04
CM-4S*	CB-4S*	.250	1.562	.750	1.000	1.031	.562	500	1/4-28	50		.05
CM-5S*	CB-5S*	.312	1.875	.875	1.250	1.219	.687	.593	5/16-24	50		.10
CM-6S	CB-6S	.359	1.938	1.000	1.250	1.562	.906	.812	3/8-24	50		.15
CM-7S	CB-7S	.406	2.125	1.125	1.375	1.750	1.062	.937	7/16-20	50		.24
CM-8S	CB-8S	.453	2.438	1.312	1.500	2.000	1.125	1.000	1/2-20	50		.35
CM-10S	CB-10S	.484	2.625	1.500	1.625	2.500	1.500	1.375	5/8-18	50		.61
CM-12S	CB-12S	.593	2.875	1.750	1.750	3.000	1.812	1.625	3/4-16	50		1.03

Rod End No.		DIMENSIONS IN MILLIMETERS								a° Misalign. Angle	Ultimate Radial Static Load Capacity Newtons	Approx. Brg. Wt. Grams
Right Hand	Left Hand	H Ref.	A ± .38	D Ref.	C +1.57 - .79	L ± .38	N ± .25	M Ref.	Thread UNF-3A			
CM-3S*	CB-3S*	5.94	31.75	15.88	19.05	25.40	6.35	11.10	10-32	50	Consult Aurora Bearing Engr. Dept.	18
CM-4S*	CB-4S*	6.35	39.67	19.05	25.40	26.19	14.27	12.70	1/4-28	50		23
CM-5S*	CB-5S*	7.92	47.63	22.23	31.75	30.96	17.45	15.06	5/16-24	50		45
CM-6S	CB-6S	9.12	49.23	25.40	31.75	39.67	23.01	20.62	3/8-24	50		68
CM-7S	CB-7S	10.31	53.98	28.58	34.93	44.45	26.97	23.80	7/16-20	50		109
CM-8S	CB-8S	11.50	61.93	33.32	38.10	50.80	28.58	25.40	1/2-20	50		159
CM-10S	CB-10S	12.29	66.68	38.10	41.28	63.50	38.10	34.93	5/8-18	50		277
CM-12S	CB-12S	15.06	73.03	44.45	44.45	76.20	46.02	41.28	3/4-16	50		467

Load ratings apply only to rod ends without grease fittings. For load ratings with fittings, please consult our engineering department.

* Grease fittings not available on these sizes. Units are supplied without grease fittings. When a grease fitting is required, specify by adding suffix as designated.

Z Zerk type fitting Ex: CM-6SZ
 F Flush type fitting Ex: CM-6SF